



**DELTA**  
**HOTELS**  
**MARRIOTT**

**ORLANDO CELEBRATION**

**FACT SHEET**

Delta Hotels Orlando Celebration  
2900 Parkway Boulevard Kissimmee, FL 34747  
407.396.7000  
www.marriott.com/mcodk

**Explore our New Look!**



**Location**

The Delta Hotels Orlando Celebration is located just 1.5 miles from Walt Disney World and near quaint, downtown Celebration. Tucked away on 20 tranquil acres of lush, tropical landscaping, the hotel is just minutes from theme parks, golf, business hubs, major highways, and a brief, 20 minute transfer to Orlando International Airport.

In addition to the new rooms and suites, guests can enjoy pools, a waterfall and slide, two tennis courts and restaurants ranging from grab and go to full-service. Guests have access to complimentary scheduled transportation to Walt Disney World, as well as Universal Studios. For meetings and events, the newly renovated convention center offers flexible space for 5-500 people.

**Guest Services**

- Complimentary WiFi
- Complimentary Business Services
- Valet Parking

**Recreation and Leisure**

- Two resort style outdoor pools with grotto waterfall, slide and hot tubs
- 24 hour fitness center, tennis courts, and sand volleyball court

**Renovated Guest Accommodations**

- 718 newly renovated guest rooms and suites
- 55" SMART TVs
- Individual Climate Control
- Mini-fridge and Coffee Maker
- Complimentary Bottled Water

**Refurbished Convention Center**

- Newly renovated convention center
- Exclusive meeting atmosphere with flexible and multiple breakout options
- Wide pre-function foyers
- Outdoor venues ideal for networking and receptions
- Experienced staff to assist with planning and execution
- Garden Gazebo perfect for weddings and social events

**New Restaurants and Lounges**

- Waves Bar and Grill – perfect spot to enjoy your favorite libation
- Marketplace – a convenient Grab-n-Go option, serving Starbucks
- Rum Shack – themed outdoor bar serving lunch and dinner poolside
- The Pointe - new restaurant serving breakfast, with private event options

**Coming Soon**

- A social lawn with fire pits for nightly gatherings
- Outdoor fitness area
- Enhanced fitness center
- Outdoor seating terrace



ORLANDO CELEBRATION

CONVENTION CENTER

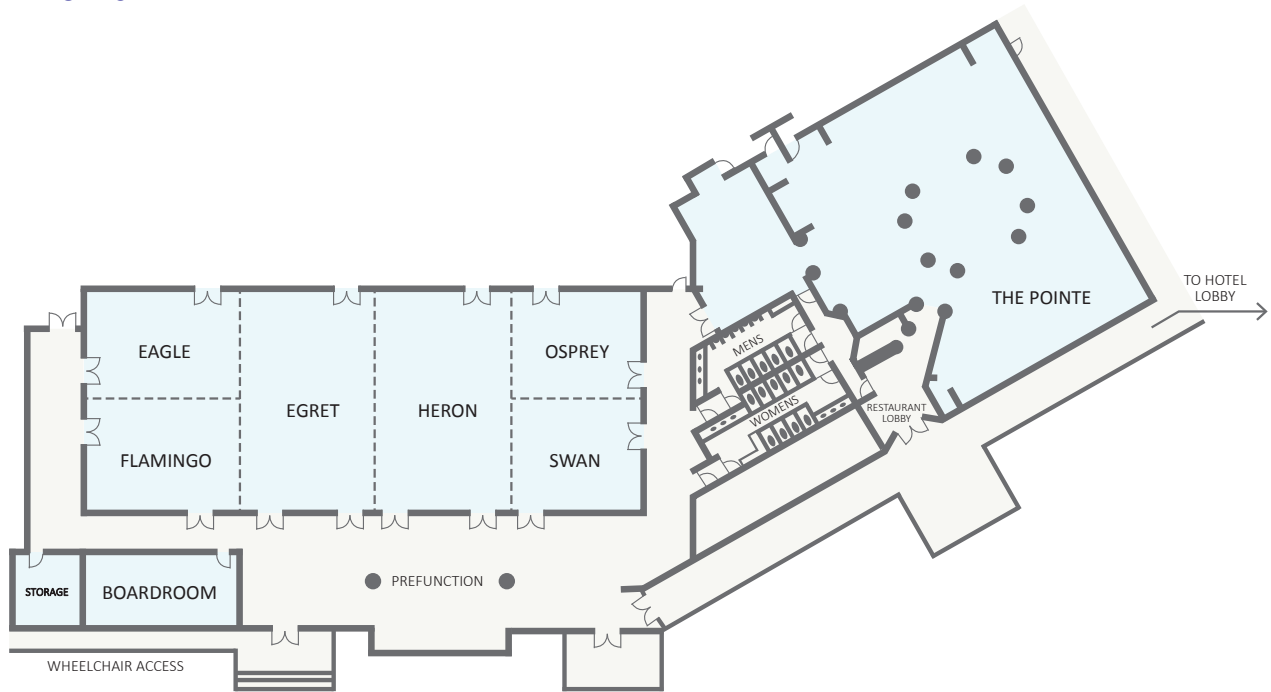

Capacity Chart

Meeting Room	Dimensions (LxWxH)	Area (sq ft)	Theater	Schoolroom	Conference	U-Shape	Reception	Banquet
<b>The Preserve Ballroom</b>	128'x45'x12'	5,760	500	350			400	350
<b>Eagle</b>	29'x23'x12'	667	60	43	20	14	50	40
<b>Flamingo</b>	29'x23'x12'	667	60	43	20	14	50	40
<b>Egret</b>	30'x45'x12'	1,350	120	85	30	25	100	80
<b>Heron</b>	30'x45'x12'	1,350	120	85	30	25	100	80
<b>Osprey</b>	29'x23'x12'	667	60	43	20	14	50	40
<b>Swan</b>	29'x23'x12'	667	60	43	20	14	50	40
<b>Boardroom</b>	25'x12'x12'	300			10			
<b>The Pointe</b>	69'x63'x0'	4,347						
<b>Gazebo Garden</b>	20'x25'x0'	500	75				75	50
<b>Social Lawn</b>	*Please contact sales							

